

TX-42



LED 

A durable, performance-minded 42" multi-touch display built on the protective NeoV™ Touch Glass for the most demanding interactive applications.

Featuring LED backlighting and Full HD panel, the TX-42 implemented with advanced optical touch solution offers precise and easy touch navigation. Upgrading to 6-touch points, its compatibility and capability fulfill a wider range of applications. In addition to the versatile connectivity, built-in HeatControl Sensor and programmable scheduler allow various digital signage applications. With the protection of anti-fingerprint NeoV™ Touch Glass, advanced Anti-Burn-in™ technology and robust metal housing, the TX-42 ensures reliable performance in engaging public environments.

- > Incorporates advanced optical touch technology
- > 6-touch points capabilities for systems with Microsoft® Windows® 7 and 8
- > Support Microsoft® Windows® 7, 8, XP, Vista, Mac OS X, Linux
- > LED-backlit technology with 1920 x 1080 Full HD resolution
- > NeoV™ Touch Glass prevents the screen from fingerprints
- > Anti-Burn-in™ technology
- > AIP technology: PIP/PBP function; 3D Comb Filter / Deinterlace / Noise Reduction
- > EcoSmart Sensor detects ambient lighting condition and automatically adjusts brightness level to reduce power consumption
- > Versatile connectivity (VGA in/out, DVI in/out, HDMI, DisplayPort, BNC in/out, S-Video, Component, Audio in/out)
- > Built-in scheduler allows different scheduled activations
- > Tiling function for easy video wall setup (supports up to 5 x 5, available in non-touch mode)
- > Flexible display orientation: portrait/ landscape
- > HeatControl Sensor prevents the display from overheating
- > RS-232 (in/out) and RJ45 for display control from a remote location
- > VESA standard wall mount
- > Built-in speakers
- > Durable metal housing
- > Rigorous screening of the components for mission-critical 24/7 applications



NeoV™ Touch Glass - The most trusted hard glass protection available. Only on AG Neovo displays



TX-42

Specifications Colleague

TX-42

Panel	Panel Type	LED-Backlit TFT LCD (IPS Panel)
	Panel Size	42.0"
	Max. Resolution	FHD 1920 x 1080
	Refresh rate	60 Hz
	Pixel Pitch	0.485 mm
	Brightness	400 cd/m ² (Typical)
	Contrast Ratio	1000 : 1 (Typical)
	Viewing Angle (H/V)	178°/178°
	Display Colour	16.7 M
Response Time (GTG)	9 ms (GTG)	
Frequency (H/V)	H Freq.	30 kHz - 75 kHz
	V Freq.	50 Hz - 75Hz
Input	VGA	15-Pin D-Sub
	DVI	24-Pin DVI-D
	S-Video	4-Pin mini DIN
	Component (YPbPr)	RCA
	HDMI	HDMI x 2
	CVBS	BNC
	DisplayPort	DisplayPort
Output	VGA	15-Pin D-Sub
	DVI	24-Pin DVI-D
	CVBS	BNC
External Control	RS-232 in/out	9-Pin D-Sub
	RJ45	RJ45
Audio	Audio In	1 x stereo audio in for PC (audio jack, 3.5 Ø) 1 x stereo audio in (RCA)
	Audio Out	1 x stereo audio out (RCA)
	Internal Speaker	12W x 2
	External Speaker Out	12W x 2
Touch Screen	Technology	Optical
	Positional Accuracy	± 3.0 mm 100% of touchable active area
	Active Force	Non-required
	Panel Interface	USB (Type-B, HID compliant)
Power	Power Supply	Internal
	Power Requirements	100 - 240V, 50-60Hz
	Consumption	< 150 W (On)
		< 0.5 W (Stand-by) < 0.5 W (Off)
NeoV™ Touch Glass	Thickness	3.0mm (0.18")
	Gloss	100GU
	Transmission Rate	> 92%
	Coating Hardness	> 8H
Operating Conditions	Temperature	0°C ~ 40°C (32°F~104°F)
	Humidity	10% ~ 80% (No condensation)
Mounting	VESA FPMPMI	Yes (400 x 200mm)
Dimensions	w/o Base (W x H x D)	985 x 578 x 131.8mm (38.8" x 22.8" x 5.2")
	w/o Base Packaging (W x H x D)	1122 x 723 x 284mm (44.2" x 28.5" x 11.2")
Weight	Product Weight	28.3 kg (62.3 lbs)
	Packaging Weight	31.9 kg (70.2 lbs)
Regulation Approval	Certifications & Compliance	FCC, CB, CE, CEL, CCC, BSMI, RoHS, GOST-R, WEEE, REACH
Accessories	Supplied	CD ROM (user manual), 15-Pin D-Sub cable, USB cable, power cord, remote control, batteries
	Optional	Stand base (STD-03)



NeoV™ Touch Glass keeps the screen protected and looking new

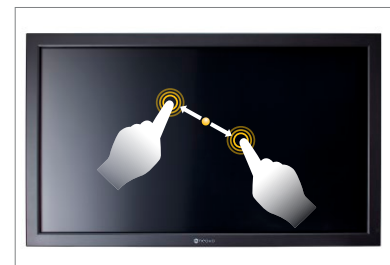

Advanced optical touch technology for accurate, zero-pressure response multi-touch gestures



Anti-Burn-in™ technology prevents image sticking



Multiple video inputs (VGA, DVI, HDMI, BNC, S-Video, DisplayPort and Component) allow for effortless system integration

