

- Video transmission over twisted pair cable
- Up to 1500m (4921ft) with UTP Cat.5e cable
- Vac or Vdc power supply
- Wide range of versions



The video transmission system over twisted pair consists in a transmitter and a receiver. The transmitter converts the composite video signal from a camera and transmit it over twisted pair, then the receiver converts again the signal in composite video. Both devices can be adjusted allowing amplification and equalisation of the signal then it is possible to cover long distances (up to 1500m for a colour video signal with UTP Cat.5e cable).

A wide range of models is available satisfying any installation requirements. The transmitter is normally supplied in a IP56 enclosure for outdoor installation: available in two versions, 12Vdc/24Vac (TWT2) and 230Vac, 50/60Hz (TWT2A). A mini version (TWM2) is also available, fed in low voltage, for installation in the outdoor camera housing. The receivers are normally supplied in a IP56 enclosure for outdoor installation: low voltage version TWRB2 12Vdc/24Vac and high voltage TWRB2A 230Vac, 50/60Hz. The receiver is also available on Europe card TWRR2, fed in low voltage, for rack installation. The new TWPL1 can bring the video, the power supply and the telemetry in one Cat.5e cable.



TWRB2

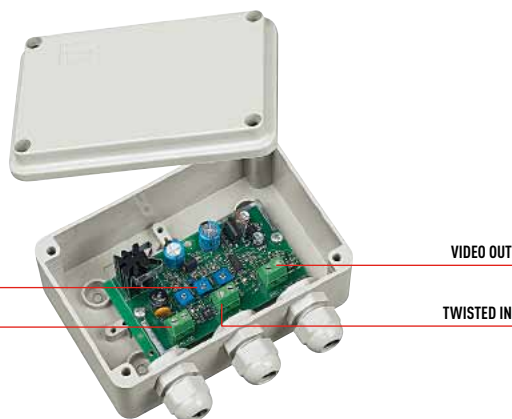

TWRB2A

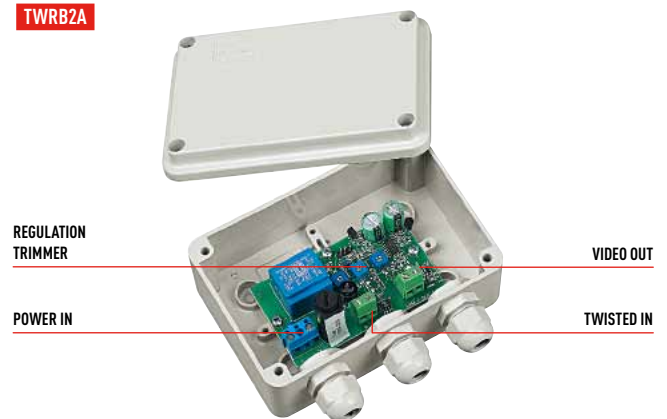

TECHNICAL DATA

GENERAL

Immunity to ground loops
 Protection against over voltage
 Active transmitters: TWM2, TWT2, TWT2A
 Active receivers: TWRR2, TWRB2, TWRB2A
 Passive transmitter and receiver: TWP, TWPL1

Max distance with UTP Cat.5e

Active transmitter and receiver
 - 1500m (4921ft) colour signal
 - 2000m (6561ft) B/W signal

Passive transmitter and receiver
 - 350m (1148ft) colour signal
 - 600m (1968ft) B/W signal

Passive transmitter TWP and receiver TWRR2, TWRB2, TWRB2A
 - 750m (2460ft) colour signal
 - 1250m (4101ft) B/W signal

Passive transmitter and receiver TWPL1
 - 100m (328ft) colour signal

Passive transmitter TWPL1 and active receiver TWRR2, TWRB2, TWRB2A
 - 750m (2460ft) colour signal

Supplied with instruction manual

Retrofit on previous models: contact VIDEOTECH for further specifications.

MECHANICAL

TWP - TWM2
 Dimensions: 40x25x63mm (1.6x0.9x2.5in) connector not included

TWPL1
 Dimensions: 22x47x32mm (0.87x1.85x1.26in) connector and cable not included

TWT2 - TWRB2 - TWT2A - TWRB2A
 Plastic enclosure
 Dimensions: 129x89x58mm (5x3.5x2.3in) cable-glands not included

TWRR2
 Dimensions: 3Ux6TEx190mm (7.5in) Eurocard

TWRC1
 Dimensions: 19", 3U/84TE

ELECTRICAL

Transmitter video input: 1.0Vpp, 75 Ohm
 Transmitter video output: 2x0.5Vpp
 Receiver video input: 0.05Vpp - 0.55Vpp
 Receiver video output: 1.0Vpp - 2.5Vpp
 Transmitter video output impedance: 110 Ohm
 Receiver video input impedance: 100 Ohm±10%
 Power supply TWT2 / TWM2 / TWRB2 / TWRR2: 12Vdc/24Vac
 Power supply TWT2A / TWRB2A: 230Vac
 Consumption max: 2W
 Power pass through TWPL1: 250mA at 300m, 1A at 30m on AWG24 cables
 Used cable UTP Cat.5e or above, 24AWG, 100 Ohm

COMMUNICATIONS

Ability to increase the distances using intermediate pairs of transmitters/receivers (in this case we recommend not exceeding 3/4 of the maximum distance for the individual sector)

With cable UTP Cat.5e

TWRC1
 Consumption: 30W

Power supply supplied with TWRC1
 - IN 100-240Vac - OUT 12Vdc, 47/63Hz, 2A

ENVIRONMENT

Indoor / Outdoor for TWT2, TWRB2, TWT2A and TWRB2A
 Indoor for TWRC1, TWP, TWPL1, TWM2 and TWRR2
 Operating temperature: -10°C / +50°C (14°F / 122 F°) for TWM2, TWT2, TWRB2, TWT2A e TWRB2A
 Operating temperature: -20°C / +75°C (-4°F / 167°F) for TWP
 Operating temperature for TWPL1: 0°C / + 85°C (32°F / +185°F)

COMPLIANCE TO

CE according to EN 61000-6-3, EN 60950-1, EN 50130-4
 TWT2, TWRB2, TWT2A and TWRB2A: IP56

| Unit Weight: | Package Weight: | Package Dimensions (WxHxL): | Master Carton: |
|------------------------------|------------------------------|--|------------------|
| TWM2 0.1kg / 0.2lb | TWM2 0.1kg / 0.2lb | TWM2 16.2x13x7cm / 6.3x5.1x2.8in | TWM2 - |
| TWT2 / TWT2A 0.1kg / 0.2lb | TWT2 / TWT2A 0.1kg / 0.2lb | TWT2 / TWT2A 16.2x13x7cm / 6.3x5.1x2.8in | TWT2 / TWT2A - |
| TWRB2 / TWRB2A 0.2kg / 0.4lb | TWRB2 / TWRB2A 0.2kg / 0.4lb | TWRB2 / TWRB2A 16.2x13x7cm / 6.3x5.1x2.8in | TWRB2 / TWRB2A - |
| TWRR2 0.1kg / 0.2lb | TWRR2 0.1kg / 0.2lb | TWRR2 22x14.5x4.6cm / 8.6x5.7x1.8in | TWRR2 - |
| TWRC1 3kg / 6.6lb | TWRC1 3.7kg / 8.2lb | TWRC1 55x30x18cm / 21.6x11.8x7in | TWRC1 - |
| TWP 0.1kg / 0.2lb | TWP 0.1kg / 0.2lb | TWP 16.2x13x7cm / 6.3x5.1x2.8in | TWP - |
| TWPL1 - | TWPL1 - | TWPL1 | TWPL1 - |